

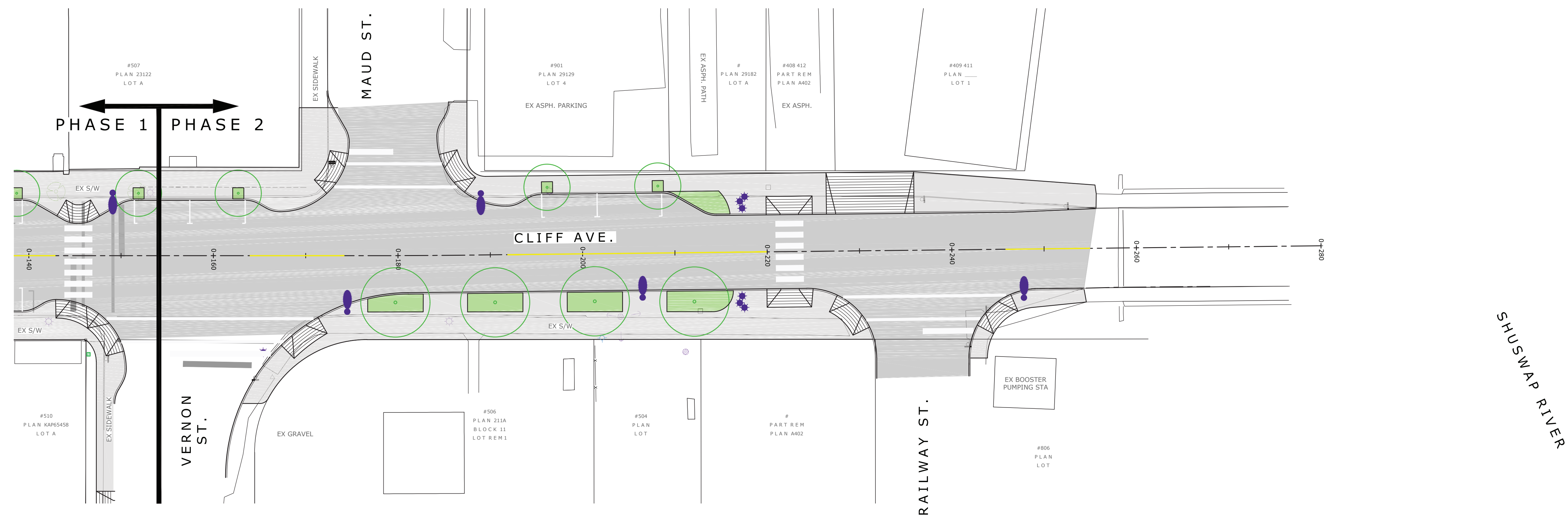

CIVIL SURFACE WORKS

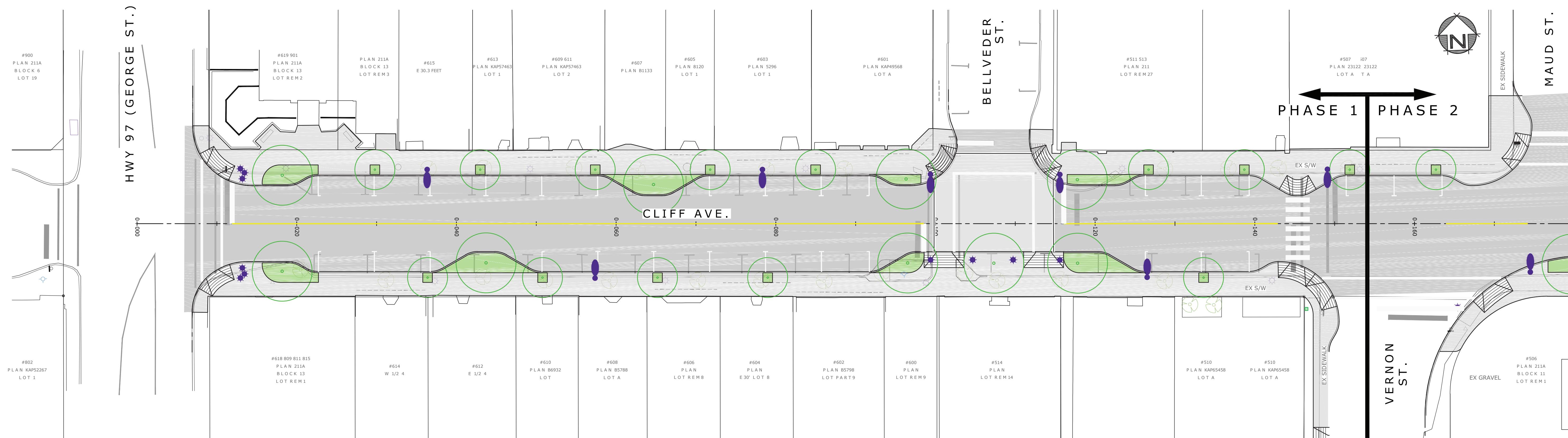

LEGEND: (PROPOSED SYMBOLS SHOWN DARK/SOLID)

- EDGE OF ASPHALT	- GUY WIRE	- PIPE INVERT
- EDGE OF GRAVEL	- ANCHOR POLE	- WATER MANHOLE
- FENCELINE	- HYDRO POLE	- WATER MAIN
- TOP OF BANK	- TEL POLE	- CURB STOP
- HEDGE	- HYDRIC VAULT	- FIRE HYDRANT
- TREELINE	- TEL VAULT	- BLOW-OFF
- SANITARY	- SAN. CABLE VAULT	
- SANITARY FORCEMAIN	- JUNCTION BOX	
- STORM DRAIN	- SERVICE BOX	
- WATER	- LIFT	
- GAS	- PROPERTY PIN	
- HYDRO/TEL	- HUB	

○ - GEODETIC MONUMENT
 ○ - SIGN
 ○ - TREE
 ○ - CEDAR SHRUB
 ○ - CAP
 ○ - REDUCER
 ○ - SANITARY CLEANOUT
 ○ - SAN. INSPECTION CHAMBER
 ○ - MANHOLE
 ○ - DRAIN CLEANOUT
 ○ - DRAIN INSPECTION CHAMBER
 ○ - CATCHBASIN MANHOLE
 ○ - CATCHBASIN
 ○ - HEADWALL

○ - PIPE INVERT
 ○ - WATER MANHOLE
 ○ - CURB STOP
 ○ - FIRE HYDRANT
 ○ - BLOW-OFF

0 5 10 15 20 25
SCALE: 1:250

